

Large Diameter Couplings OD355.6 - 816

Datasheet

1/4

Coupling

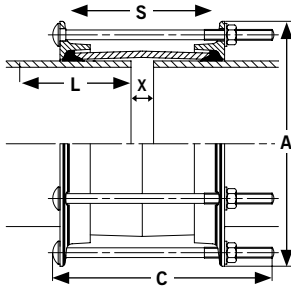

Coupling Type	Coupling Section Type	Sleeve Length S (mm)	Dimensions (mm)		Setting Gap X (mm)		Bolt Details		
			Distance L	Overall C	Min.	Max.	Bolt Dia.	Length (mm)	Torque (Nm)
Standard Sleeve	L02	150	150	243	25	50	M12	235	55 - 65
Long Sleeve	L03	250	200	348	25	150	M12	340	55 - 65
Standard Sleeve	YF2	178	150	276	38	76	M16	265	95 - 120
Long Sleeve	YF3	250	200	351	38	150	M16	340	95 - 120
Standard Sleeve	A2E	178	150	276	38	76	M16	265	95 - 120
Long Sleeve	A2H	254	200	351	38	150	M16	340	95 - 120
Standard Sleeve	XSVG	254	200	411	57	117	M16	400	95 - 120

L= Distance back from end of pipe that must be rounded, meet tolerances, and free from any wrapping to ensure correct assembly.

Large Diameter Couplings

Pipe OD (mm)	Pipe Material	Working Pressure (bar)	Gasket Mould No.	Tolerance (mm) on Pipe OD for Distance L (mm)		Coupling Section Type		Bolts No. x Dia	Weight (kg)		Diameter A (mm)
				+	-	Standard Sleeve	Long Sleeve		Standard Sleeve	Long Sleeve	
355.6	Steel & uPVC	23.2	J51LS	1.6	1.6	L02	L03	6 x M12	19.6	26.3	447
355.6	Steel	31.0	J51LS	1.6	1.6	L02	L03	8 x M12	20.0	26.9	447
358.6	Coated Steel	19.6	J51LS	1.6	1.6	L02	L03	6 x M12	19.7	26.5	450
358.6	Coated Steel	30.7	J51LS	1.6	1.6	L02	L03	8 x M12	20.2	27.1	450
378	Ductile Iron	29.2	J52LS	2.7	3.5	L02	L03	8 x M12	21.1	28.4	469
406.4	Steel & uPVC	27.2	J53LS	1.6	1.6	L02	L03	8 x M12	22.4	30.2	497
408.4	Coated Steel	27.0	J53LS	1.6	1.6	L02	L03	8 x M12	22.5	30.4	499
409.6	Coated Steel	27.0	J53LS	1.6	1.6	L02	L03	8 x M12	22.6	30.4	500
429	Ductile Iron	25.8	J54LS	2.8	4.0	L02	L03	8 x M12	23.6	31.7	520
457	Steel & uPVC	24.2	J55LS	1.6	1.6	L02	L03	8 x M12	24.9	33.5	548
460	Coated Steel	24.1	J55LS	1.6	1.6	L02	L03	8 x M12	25.0	33.7	551
480	Ductile Iron	23.1	J56LS	2.9	4.0	L02	L03	8 x M12	26.0	35.1	571
480	Ductile Iron	28.9	J56LS	2.9	4.0	L02	L03	10 x M12	26.5	35.7	571
508	Steel & uPVC	27.4	J57LS	1.6	1.6	L02	L03	10 x M12	27.8	37.4	598
511	Coated Steel	27.2	J57LS	1.6	1.6	L02	L03	10 x M12	27.9	37.6	602
532	Ductile Iron	26.1	J58LS	3.0	4.0	L02	L03	10 x M12	29.0	39.1	624
559	Steel & uPVC	24.9	J59LS	1.6	1.6	L02	L03	10 x M12	30.2	40.7	649
610	Steel & uPVC	22.9	J60LS	1.6	1.6	L02	L03	10 x M12	32.7	44.1	701
610	Steel	26.3	J60LS	1.6	1.6	L02	L03	12 x M12	33.1	44.6	701
613	Coated Steel	22.8	J60LS	1.6	1.6	L02	L03	10 x M12	32.8	44.3	704
613	Coated Steel	26.2	J60LS	1.6	1.6	L02	L03	12 x M12	33.2	44.8	704
635	Ductile Iron	22.0	J61LS	3.2	4.5	L02	L03	10 x M12	33.9	45.8	726
635	Ductile Iron	25.2	J61LS	3.2	4.5	L02	L03	12 x M12	34.3	46.3	726
660	Steel	24.3	J61LS	1.6	1.6	L02	L03	12 x M12	35.5	47.9	751
660	Steel	31.5	J61LS	1.6	1.6	YF2	YF3	10 x M16	62.6	74.5	770
663	Coated Steel	24.3	J61LS	1.6	1.6	L02	L03	12 x M12	35.7	48.1	754
663	Coated Steel	31.4	J61LS	1.6	1.6	YF2	YF3	10 x M16	62.9	74.8	773
711	Steel	22.6	J63LS	1.6	1.6	L02	L03	12 x M12	38.1	51.3	802
714	Coated Steel	22.4	J63LS	1.6	1.6	L02	L03	12 x M12	38.1	51.5	805
738	Ductile Iron	21.7	J63LS	3.4	4.5	L02	L03	12 x M12	39.3	53.1	830
738	Ductile Iron	28.2	J63LS	3.4	4.5	YF2	YF3	10 x M16	69.3	82.4	849
762	Steel	21.0	J64LS	1.6	1.6	L02	L03	12 x M12	40.4	54.6	852
762	Steel	27.3	J64LS	1.6	1.6	YF2	YF3	10 x M16	71.2	84.6	871
765	Coated Steel	21.0	J64LS	1.6	1.6	L02	L03	12 x M12	40.6	54.8	856
765	Coated Steel	27.2	J64LS	1.6	1.6	YF2	YF3	10 x M16	71.5	85.0	875
813	Steel	19.8	J65LS	1.6	1.6	L02	L03	14 x M12	43.3	58.5	903
816	Coated Steel	19.7	J65LS	1.6	1.6	L02	L03	14 x M12	43.3	58.7	906

Every effort has been made to ensure that the information contained in this publication is accurate at the time of publishing. Crane Ltd assumes no responsibility or liability for typographical errors or omissions or for any misinterpretation of the information within the publication and reserves the right to change without notice.

DR8550_03_2020_ISSUE 6

Technical Information

Viking Johnson manufacture couplings to any pipe OD and pressure. If the product required is not shown in any of our tables please contact Viking Johnson who can provide the relevant information.

Working Pressure Rating

For Water / Wastewater applications as detailed in Large Diameter Coupling Technical Data Table.

Gas 6 bar

Vacuum Pressure

Capable of accommodating a vacuum pressure of -0.7 bar

Site Test Pressure

1.5 times working pressure for short duration (2 hours)

End Load Due to Internal Pressure

Dedicated Couplings DO NOT resist end load due to the internal pressure - adequate external restraint must be provided to prevent pipe pull out from the coupling.

Temperature Rating of Product

EPDM -20°C to +90°C

Nitrile -20°C to +90°C

Other Gasket Grades Contact Viking Johnson.

For use on applications with fluctuating and / or elevated temperatures (> 60°C) may require regular maintenance to re-tighten the bolts and must be included in any maintenance schedule.

Approvals

The following water contact materials used in Large Diameter Dedicated products are approved for use with potable water:-

Rilsan Nylon 11:

- WRAS, AS/NZS 4020, DVGW, W270, ACS & KIWA.

EPDM Gaskets:

- WRAS, AS/NZS 4020

In addition to the above, LD Dedicated range as a finished product has KIWA certification verifying that the above products comply with the requirements of the Water Supply (Water Fittings) Regulations for England and Wales 1999, the Water Byelaws 2000, Scotland and the Water Regulations Northern Ireland.

Materials & Relevant Standards

Centre Sleeve & End Rings

Steel to BS EN10025-2: Grade S275JR

Gaskets: LO2/LO3/YF2/YF3

Rubber 80 IRHD Moulded Compound to BS EN681-1:

Type WA,WC,WG

BS EN682: Type G

(other materials available on request)

Gaskets: A2E/A2H/XSXG

Rubber 70 IRHD Moulded Compound to BS EN681-1:

Type WA, WC, WG

BS EN682: Type G

(other materials available on request)

Coatings

Body, Flange & End Ring:

- Rilsan Nylon 11 to WIS 4-52-01 Part 1

Nuts & Bolts:

- Sheraplex coated to WIS 4-52-03

Bolts

Steel to BS EN ISO898-1: Property Class 4.8

Nuts

Steel to BS4190: Grade 4

Washers

Stainless Steel to BS1449:Part 2: Grade 304S15

Large Diameter Couplings OD842 - 2038

Coupling

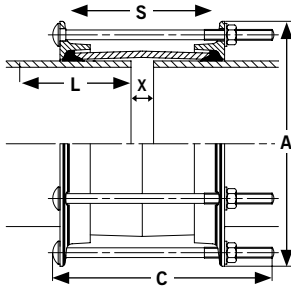

Coupling Type	Coupling Section Type	Sleeve Length S (mm)	Dimensions (mm)		Setting Gap X (mm)		Bolt Details		
			Distance L	Overall C	Min.	Max.	Bolt Dia.	Length (mm)	Torque (Nm)
Standard Sleeve	L02	150	150	243	25	50	M12	235	55 - 65
Long Sleeve	L03	250	200	348	25	150	M12	340	55 - 65
Standard Sleeve	YF2	178	150	276	38	76	M16	265	95 - 120
Long Sleeve	YF3	250	200	351	38	150	M16	340	95 - 120
Standard Sleeve	A2E	178	150	276	38	76	M16	265	95 - 120
Long Sleeve	A2H	254	200	351	38	150	M16	340	95 - 120
Standard Sleeve	XSXG	254	200	411	57	117	M16	400	95 - 120

L= Distance back from end of pipe that must be rounded, meet tolerances, and free from any wrapping to ensure correct assembly.

Large Diameter Couplings

Pipe OD (mm)	Pipe Material	Working Pressure (bar)	Gasket Mould No.	Tolerance (mm) on Pipe OD for Distance L		Coupling Section Type		Bolts No. x Dia	Weight (kg)		Diameter A (mm)
				+	-	Standard Sleeve	Long Sleeve		Standard Sleeve	Long Sleeve	
842	Ductile Iron	18.9	J65LS	1.0	4.5	L02	L03	14 x M12	44.6	60.3	931
842	Ductile Iron	25.0	J65LS	1.0	4.5	YF2	YF3	12 x M16	78.7	93.6	950
842	Ductile Iron	29.1	J116M	1.0	4.5	A2E	A2H	14 x M16	103.4	122.7	965
864	Steel	17.9	J66LS	1.6	1.6	L02	L03	14 x M12	45.7	61.8	955
864	Steel	28.4	J116M	1.6	1.6	A2E	A2H	14 x M16	105.9	125.8	988
867	Coated Steel	17.8	J66LS	1.6	1.6	L02	L03	14 x M12	45.9	62.0	958
867	Coated Steel	28.2	J117M	1.6	1.6	A2E	A2H	14 x M16	106.3	126.2	992
914	Steel	16.0	J67LS	1.6	1.6	L02	L03	14 x M12	48.2	65.1	1005
914	Steel	26.8	J117M	1.6	1.6	A2E	A2H	14 x M16	111.6	132.4	1039
916	Coated Steel	16.0	J67LS	1.6	1.6	L02	L03	14 x M12	48.3	65.2	1007
916	Coated Steel	26.8	J117M	1.6	1.6	A2E	A2H	14 x M16	111.8	132.7	1041
945	Ductile Iron	22.0	J70LS	1.0	5.0	YF2	YF3	12 x M16	87.5	104.0	1054
945	Ductile Iron	25.9	J118M	1.0	5.0	A2E	A2H	14 x M16	115.0	136.5	1069
1016	Steel	19.6	J71LS	1.6	1.6	YF2	YF3	14 x M16	94.3	112.2	1125
1019	Coated Steel	19.4	J71LS	1.6	1.6	YF2	YF3	14 x M16	94.6	112.5	1129
1048	Ductile Iron	18.4	J71LS	1.0	5.0	YF2	YF3	14 x M16	96.9	115.3	1156
1048	Ductile Iron	26.8	J119M	1.0	5.0	A2E	A2H	16 x M16	127.1	151.0	1171
1067	Steel	17.7	J72LS	1.6	1.6	YF2	YF3	14 x M16	98.6	117.3	1177
1067	Steel	26.3	J119M	1.6	1.6	A2E	A2H	16 x M16	129.4	153.7	1192
1070	Coated Steel	17.6	J72LS	1.6	1.6	YF2	YF3	14 x M16	98.9	117.6	1180
1070	Coated Steel	26.2	J120M	1.6	1.6	A2E	A2H	16 x M16	129.7	154.1	1195
1118	Steel	16.2	J73LS	1.6	1.6	YF2	YF3	14 x M16	102.9	122.4	1227
1121	Coated Steel	16.0	J73LS	1.6	1.6	YF2	YF3	14 x M16	103.2	122.8	1231
1152	Ductile Iron	24.4	J121M	1.0	6.0	A2E	A2H	16 x M16	138.7	164.7	1275
1219	Steel	23.0	J121M	1.6	1.6	A2E	A2H	16 x M16	146.3	173.7	1343
1222	Coated Steel	23.0	J121M	1.6	1.6	A2E	A2H	16 x M16	146.6	174.1	1347
1255	Ductile Iron	25.2	J122M	1.0	6.0	A2E	A2H	18 x M16	151.0	179.4	1378
1422	Steel	24.5	J125M	1.6	3.0	A2E	A2H	20 x M16	170.5	202.6	1546
1426	Coated Steel	24.4	J125M	1.6	3.0	A2E	A2H	20 x M16	171.0	203.1	1551
1462	Ductile Iron	23.8	J125M	1.0	7.0	A2E	A2H	20 x M16	174.8	207.7	1585
1620	Steel	20.3	J127M	3.0	3.0	A2E	A2H	24 x M16	192.4	230.9	1745
1626	Coated Steel	20.2	J127M	3.0	3.0	A2E	A2H	24 x M16	194.2	231.7	1751
1668	Ductile Iron	19.2	J128M	1.0	7.0	A2E	A2H	24 x M16	199.4	237.0	1791
1829	Steel	16.0	J130M	3.0	3.0	A2E	A2H	24 x M16	217.5	258.5	1954
1835	Coated Steel	24.0	J184H	3.0	3.0	XSXG	-	32 x M16	378.4	-	1970
2032	Steel	22.1	J186H	3.0	3.0	XSXG	-	36 x M16	418.6	-	2167
2038	Coated Steel	22.0	J186H	3.0	3.0	XSXG	-	36 x M16	419.7	-	2173

Every effort has been made to ensure that the information contained in this publication is accurate at the time of publishing. Crane Ltd assumes no responsibility or liability for typographical errors or omissions or for any misinterpretation of the information within the publication and reserves the right to change without notice.

DR8550_03_2020_ISSUE 6

Technical Information

Viking Johnson manufacture couplings to any pipe OD and pressure. If the product required is not shown in any of our tables please contact Viking Johnson who can provide the relevant information.

Working Pressure Rating

For Water / Wastewater applications as detailed in Large Diameter Coupling Technical Data Table.

Gas 6 bar

Vacuum Pressure

Capable of accommodating a vacuum pressure of -0.7 bar

Site Test Pressure

1.5 times working pressure for short duration (2 hours)

End Load Due to Internal Pressure

Dedicated Couplings DO NOT resist end load due to the internal pressure - adequate external restraint must be provided to prevent pipe pull out from the coupling.

Temperature Rating of Product

EPDM -20°C to +90°C

Nitrile -20°C to +90°C

Other Gasket Grades Contact Viking Johnson.

For use on applications with fluctuating and / or elevated temperatures (> 60°C) may require regular maintenance to re-tighten the bolts and must be included in any maintenance schedule.

Approvals

The following water contact materials used in Large Diameter Dedicated products are approved for use with potable water:-

Rilsan Nylon 11:

- WRAS, AS/NZS 4020, DVGW, W270, ACS & KIWA.

EPDM Gaskets:

- WRAS, AS/NZS 4020

In addition to the above, LD Dedicated range as a finished product has KIWA certification verifying that the above products comply with the requirements of the Water Supply (Water Fittings) Regulations for England and Wales 1999, the Water Byelaws 2000, Scotland and the Water Regulations Northern Ireland.

Materials & Relevant Standards

Centre Sleeve & End Rings

Steel to BS EN10025-2: Grade S275JR

Gaskets: LO2/LO3/YF2/YF3

Rubber 80 IRHD Moulded Compound to BS EN681-1:

Type WA,WC,WG

BS EN682: Type G

(other materials available on request)

Gaskets: A2E/A2H/XSXG

Rubber 70 IRHD Moulded Compound to BS EN681-1:

Type WA, WC, WG

BS EN682: Type G

(other materials available on request)

Coatings

Body, Flange & End Ring:

- Rilsan Nylon 11 to WIS 4-52-01 Part 1

Nuts & Bolts:

- Sheraplex coated to WIS 4-52-03

Bolts

Steel to BS EN ISO898-1: Property Class 4.8

Nuts

Steel to BS4190: Grade 4

Washers

Stainless Steel to BS1449:Part 2: Grade 304S15